

# BALUSTRADES & OPEN BALCONIES

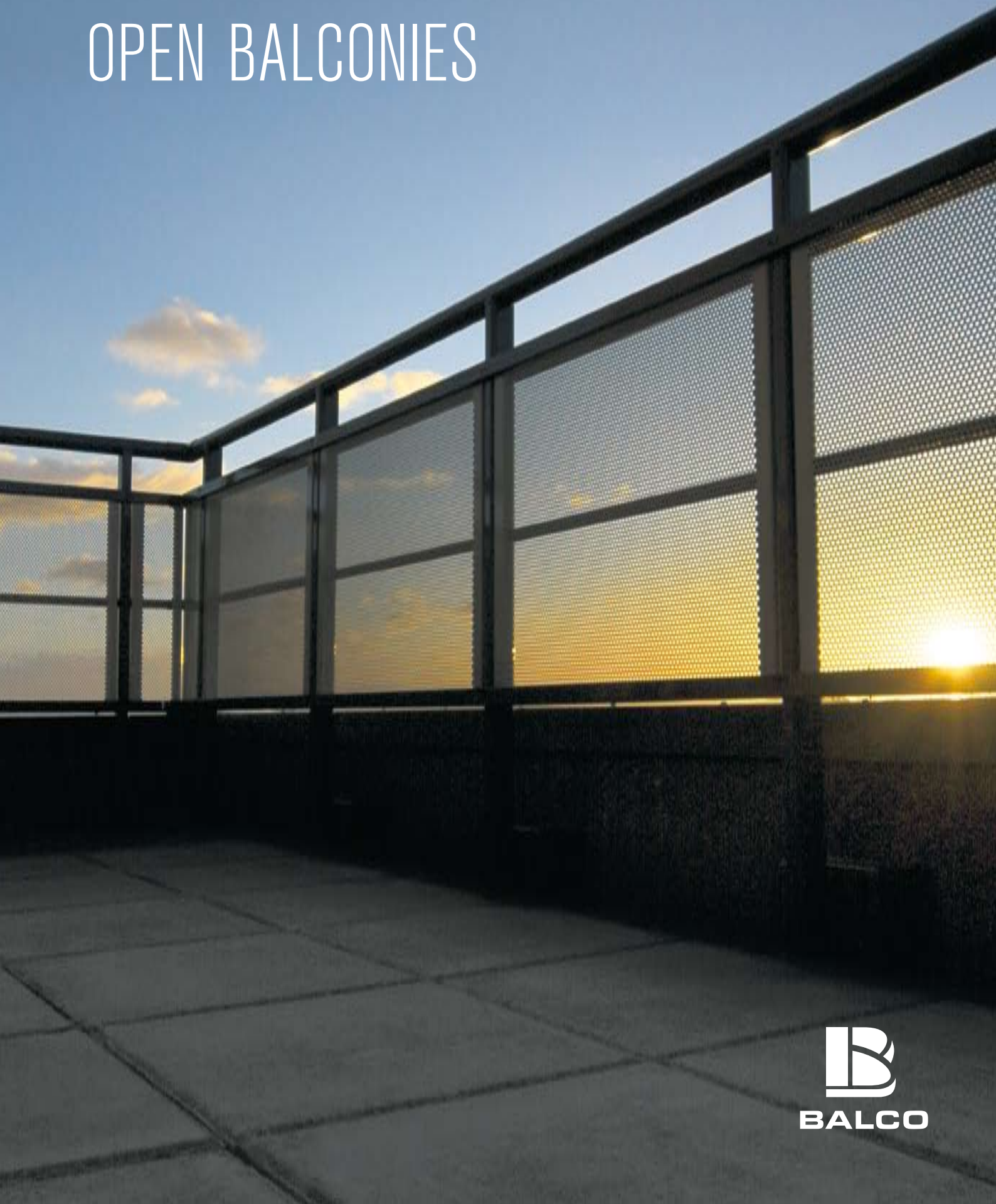

**BALCO**

»High quality and long experience combined with sound and solid finances make us a reliable and stable partner«



## EVERYTHING FOR OPEN BALCONIES

Perhaps you want to combine glazed balconies with open ones, or leave the glazing until a later date. Whatever drives your choices, we have some great

products to offer. Our complete range for open balconies includes balustrades, roofing and side screens. We also have cost-effective solutions for

adding glazing to existing private and access balconies – all offering the same quality you will find in our glazing systems. Contact us to find out more.



### ROBUST LIGHTWEIGHT

Although the balcony floor modules are cast in a robust steel frame, the light aluminium balustrades help keep the overall weight low.

**WHERE:** Northampton  
**NO. OF BALCONIES:** 55  
**BALUSTRADE:** Perforated aluminium, round handrail, posts and decorative tubing in aluminium.



## LIGHTER LOAD

These balconies in Northampton in the UK are an excellent example of how our complete range for open balconies can help to improve the look of a whole building. Durable materials that have a long lifespan and minimum maintenance. Also light and so easy to install. The balustrades and handrails are colourcoordinated to merge in with the colour scheme on the rest of the building. Our extensive experience also ensures efficient planning and production, keeping the collaboration with property owners and architects nice and simple. A lighter load, in all sorts of ways.

## A NATURAL ELEMENT

After oxygen and silicon, aluminium is the most abundant element in the earth's crust. It is also a light and maintenance-free metal that gives our balustrades a low overall weight and long lifespan. An unbeatable combination.



## LIKE WROUGHT IRON

A stylish solution that melts in and gives a solid impression. The light aluminium balustrade looks, from a distance, like wrought iron. The whole solution is also prepared to take glazing at a later date.

### WHERE:

Storängsgatan, Växjö

**NO. OF BALCONIES:** 20

**BALUSTRADE:** Specialist grille to look like wrought iron.



## SHELTERED SPOT

Gently curved sheet metal that shields the balcony from view and frosted glass in the side screens for shelter without losing light. The combination has become an integral part of the building's architecture and created a lovely space for the residents.

### WHERE:

Beckomberga, Stockholm

**NO. OF BALCONIES:** 31

**BALUSTRADE:** Clear glass in a frame with curved sheet metal along the front and a side screen in frosted glass. Handrail in aluminium.



## CLEAR VIEW

Lightly smoked glass in a frame plus the choice of wood for the walls and window frames increases the sense of being part of the natural surroundings. These spacious balconies give the residents a superb outdoor space, just on the cusp between inside and out.

### WHERE:

Pälaträdan, Växjö

**NO. OF BALCONIES:** 48

**BALUSTRADE:** Laminated glass with aluminium frame and handrail.



## FITS RIGHT IN

Integrating the balconies with the corners of the building gives these outdoor spaces a sheltered position, so that residents can sit out of the wind. The opalised glass in a frame adds extra screening from view – while also letting through plenty of light.

### WHERE:

Haga Bunkeflo, Malmö

**NO. OF BALCONIES:** 80

**BALUSTRADE:** Opalised glass with aluminium frame and handrail.



## COURTYARD SPLENDOUR

The Utsädet development chose balustrades with matching handrails for the private and access balconies overlooking the inner courtyard. The clear glass accentuates the light and airy look.

### WHERE:

Karl XII Gata, Lund

**NO. OF BALCONIES:** 77

plus 4 access balconies  
**BALUSTRADE:** Grille with glass panels and matching handrail.

## UNIQUE LOOK

Here, the architect chose a specially designed perforated pattern in sheet metal to give the balconies a unique look. The residents are screened from view without losing light – and also have glimpses out when sitting down.

**WHERE:** Hammarby Sjöstad, Stockholm  
**NO. OF BALCONIES:** 82  
**BALUSTRADE:** Perforated sheet metal in a specially designed pattern.



## UNIQUE PROJECT

These properties are part of by far Sweden's largest single timber building project. Our balconies in sustainable and ecofriendly materials fit beautifully into this major initiative, which is being closely monitored by universities and research institutes.

**WHERE:** Limnologen, Växjö  
**NO. OF BALCONIES:** 134  
**BALUSTRADE:** Clear glass with black aluminium frames mounted on existing wooden posts.



## ALL-IN CONTRACT

Investing in open balconies for a building or a whole estate is a major decision. Many people are involved in the decision-making process, and a whole host of questions will crop up along the way. It is always easy to miss something. With Balco, you get a reliable, stable partner through the whole construction process, from the first tentative questions to the final warranty inspection.



# BALUSTRADES & OPEN BALCONIES

We have the complete range for open balconies including balustrades, dividing screens, roofing and side screens – all offering the same quality you will find in our glazing systems. That's why we are the market leader. There are in fact no limits. Even if an apartment has no opening and floor module, it is still possible to build a balcony. Our design department has many years' experience of both possible and apparently impossible projects.



- 1 Floor module and fixings
- 2 Balustrade
- 3 Cladding
- 4 Screens
- 5 Roof

## 1 FLOOR MODULE AND COMPLETE FIXING SYSTEM



### Floor module

**THE BALCONY FLOOR**  
Conditions always vary. There is usually an existing floor module that we can retain or extend. Sometimes we make a completely new one.

Our concrete floor modules are made to handle the majority of conditions and weigh around half as much as an ordinary concrete floor. The concrete is cast in a frame of hot-galvanised steel.

Naturally, we can also supply conventional concrete solutions.



### Complete fixing system

**A SYSTEM WITH HIGH TOLERANCES**  
Our design department makes careful calculations to ensure that the fixings and other technical details are tailored to the item in question.

The telescopic fixing allows us to compensate for any deviations in a building. It also allows safe and efficient installation.



## 2 BALUSTRADE

All our balustrades are made of gently rounded aluminium profiles that can be lacquered in your colour of choice – from the RAL scale as standard or from the NCS scale for an additional charge. Two of our handrails are also prepared for the fitting of a window box.

- A** Handrail
- B** Post bracket with fittings
- C** Post bracket for fitting to front edge
- D** Upper and lower cladding support rail
- E** Frame profile
- F** Cladding

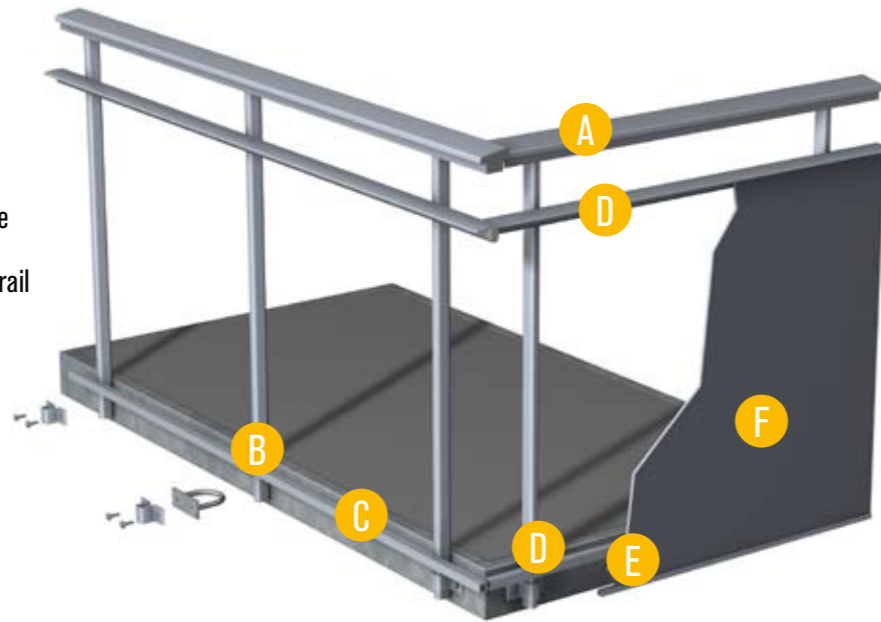

### Handrail

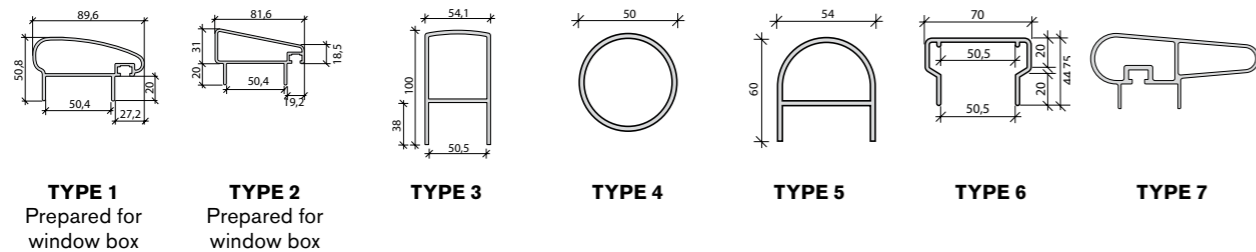

### Cladding support rail



### Vertical support post

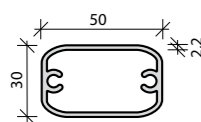

### Access system support post

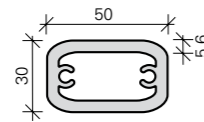

## 3 CLADDING

The choice of cladding is key to the balcony's appearance and the character of the whole façade. The cladding is available in a host of different colours and materials. The combination of cladding and handrail is what gives the balcony its specific look. Choose from a wide range of materials, most of which can be coloured. The cladding can be fitted internally or externally. Choosing the latter option hides the posts and the floor module.

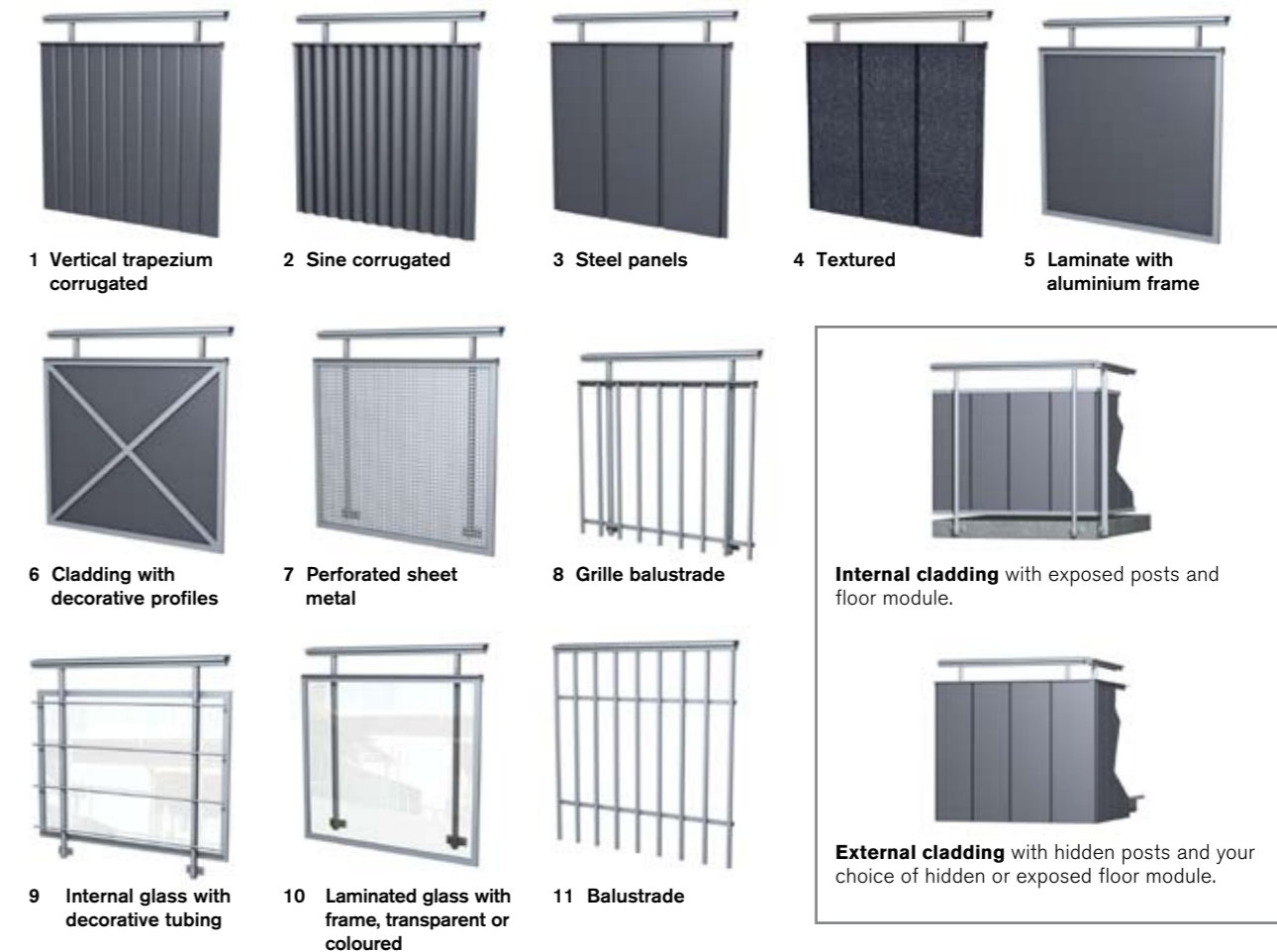

### Decorative tubing

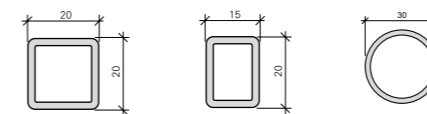

### Cladding

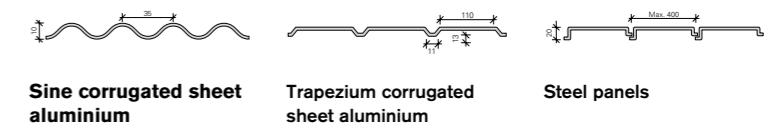

### For glass, laminate and other sheeting

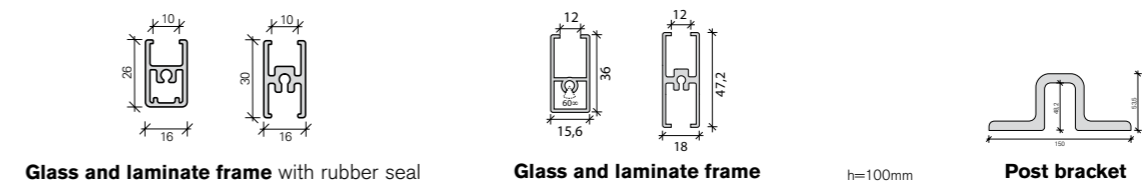

## 4 SCREENS

The need for weather protection and privacy will determine the choice of materials and design. The variations are actually endless – challenge us and see what we can do!

### Dividing screen

#### THE WALL BETWEEN TWO BALCONIES

It usually only takes a simple type of screen to create a barrier between two neighbouring balconies. The most common material is perforated mesh or opaque laminated glass, which is available in all sorts of variations. Let the need for screening and privacy guide your choice.



### Return Screen

#### THE OUTSIDE WALL OF THE BALCONY

Above the cladding, it can be good to screen the balcony off from wind and rain. Choose from our range of designs and materials. If you want a side screen to give added privacy, choose a material that is not transparent.



Low side screen with straight corner



High side screen

## 5 ROOF

The roof is designed to handle all expected loads by a wide margin. The roof is clad in foiled polycarbonate as standard and can be attached in many different ways, depending on the circumstances. A range of other materials are available as optional extras.



Standard roof with braces anchored in the steel posts.



Standard roof with vertical supports fixed to the balcony floor.



Cantilever roof fixed directly into the wall.



Cantilever roof fixed directly into the steel posts.

### SUPPLEMENTARY GLAZING

We can also create a comfortable outdoor space by building inside an existing balustrade.

**Sweden (HQ)**

Balco AB  
Älgvägen 4  
352 45 Växjö  
Phone +46 470-53 30 00  
Fax +46 470-53 30 97  
balco@balco.se  
www.balco.se

**Norway**

Balco AS  
Sandstuveien 60A  
1184 Oslo  
Phone +47 23 38 12 00  
Fax +47 23 38 12 01  
balco@balco.no  
www.balco.no

**Denmark**

Balco AS  
Industriholmen 15 B  
2650 Hvidovre  
Phone +45 57 83 13 50  
Fax +45 57 83 43 50  
balco@balco.dk  
www.balco.dk

**Germany**

Balco GmbH  
Schönefelder Chaussee 233  
125 24 Berlin  
Phone +49 30 634 998 25  
Fax +49 30 634 998 24  
balco@balco.de  
www.balco.de

**UK**

Balco Balcony Systems Ltd  
136 Tuffley Avenue  
Gloucester, GL1 5NS  
Phone +44 1452 559 404  
Fax +44 1452 559 404  
balco@balcouk.com  
www.balcouk.com

Production: United Reklambyrå, 2008-11/382GB. Photos: Shutterpoint Photography, Micke Persson.  
Illustrations: Illustrationsbolaget. Repro: Fyra Punkter. Printing: Davidsons Tryckeri.

We reserve the right to make product changes, technical modifications and changes for legal reasons.

